



## Double Door - Divided Opening With Shelves Worksheet

Uses 4 "L" Bracket Installation On Base Shelves & As Noted On Left For Upper Or Middle Shelves

### The no middle shelf type cabinet will use:

The 4 "L" bracket method of installation for the base shelves & 2 "RB" bracket method for the upper shelves

### The half depth middle shelf will use:

The 4 "L" bracket method of installation for the base shelves & 2 "RB" bracket method for the upper shelves

### The full depth middle shelf will use:

The 4 "L" bracket method of installation for base shelves and upper shelves

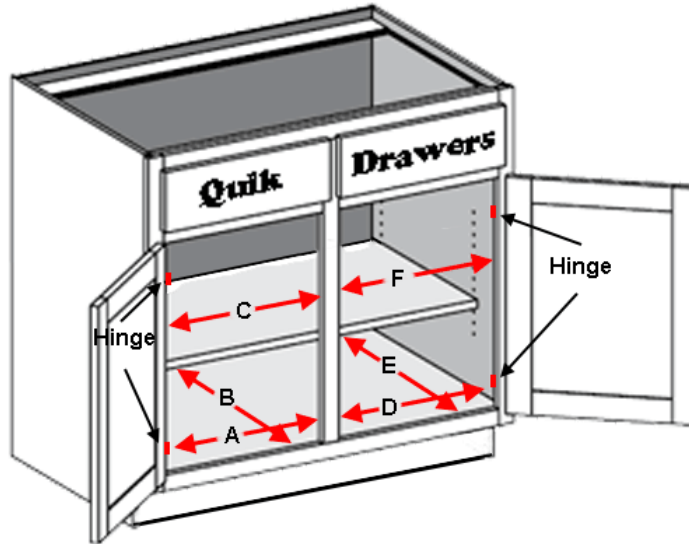

This drawing will require the same measurements regardless of mid shelf type.

4 "L" bracket installation *always* for base shelves

A & D - From hinge to hinge (if present), otherwise from side of frame opening to opposite side of frame opening

B & E - From rear wall to inside of face frame

C & F - From side of frame opening to opposite side of frame opening, should be area clear of hinges

- A,D** Record the measurement from hinge to opposite side of opening. If there is no hinge, then measure from side of opening to opposite side of opening.
- B,E** Record the measure from the rear wall to the inside edge of the front face frame
- C,F** Record the distance from one side of the opening to the opposite side of the opening. The upper shelf area should be clear of any hinges

Cabinet #	"A"	"B"	"C"	"D"	"E"	"F"
_____	_____	_____	_____	_____	_____	_____
_____	_____	_____	_____	_____	_____	_____
_____	_____	_____	_____	_____	_____	_____
_____	_____	_____	_____	_____	_____	_____
_____	_____	_____	_____	_____	_____	_____